

PROPOSED BOUNDARY MAP OF  
 COMMUNITY FACILITIES DISTRICT NO. 2020-1 OF THE  
 MORENO VALLEY UNIFIED SCHOOL DISTRICT  
 RIVERSIDE COUNTY  
 STATE OF CALIFORNIA

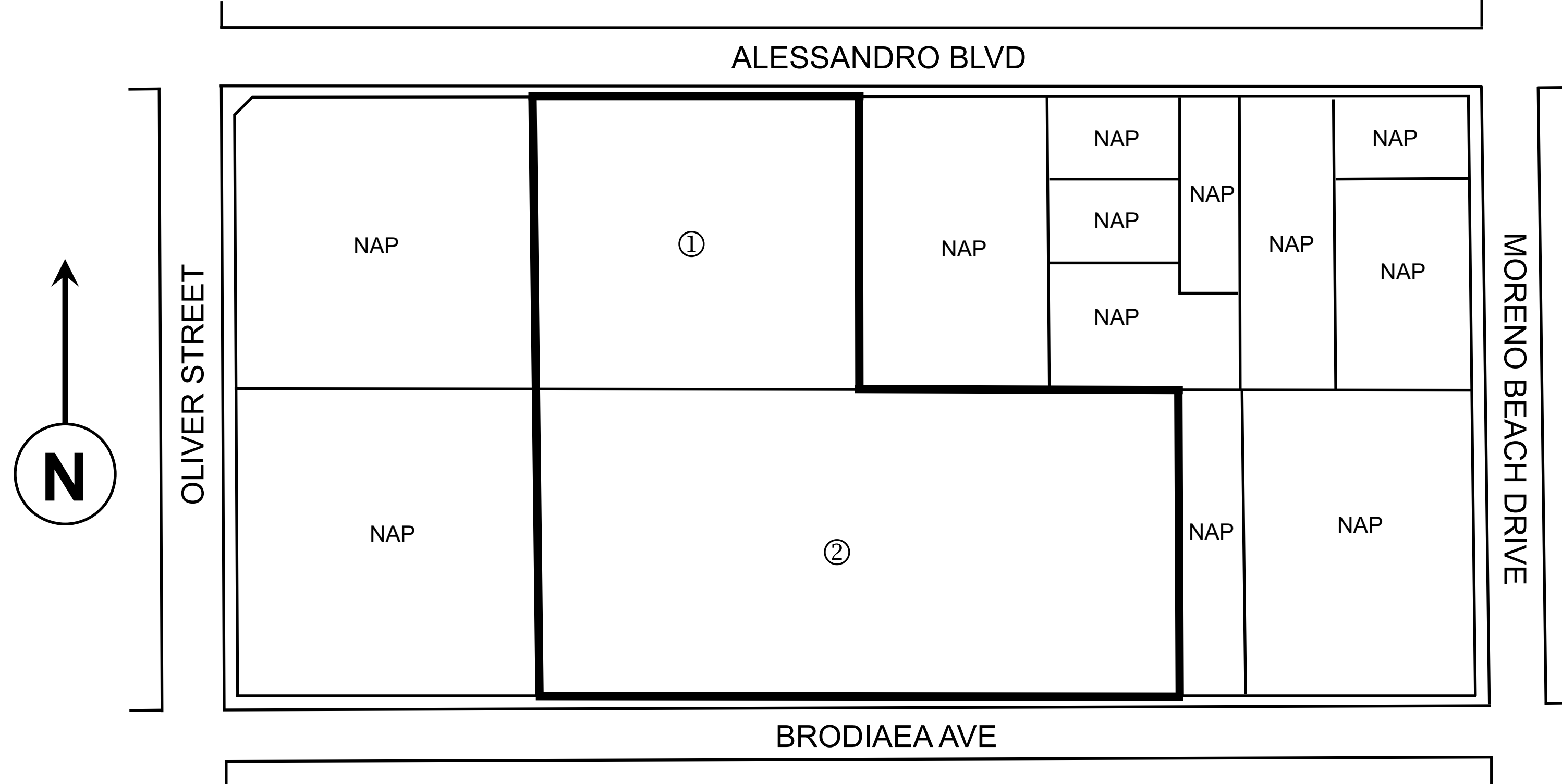

(1) Filed in the office of the Clerk of the Board of Education of the Moreno Valley Unified School District this \_\_\_ day of \_\_\_\_\_, 20\_\_

\_\_\_\_\_, Clerk of the Board of Education  
 Moreno Valley Unified School District

(2) I hereby certify that the within map showing the proposed boundaries of Community Facilities District No. 2020-1 of the Moreno Valley Unified School District, Riverside County, State of California, was approved by the Board of Education of the Moreno Valley Unified School District at the regular meeting thereof, held on this \_\_\_ day of \_\_\_\_\_, 20\_\_ by its Resolution No. \_\_\_\_\_.

\_\_\_\_\_, Clerk of the Board of Education  
 Moreno Valley School District

(3) Filed this \_\_\_\_\_ day of \_\_\_\_\_, 2020, at the hour of \_\_\_\_\_ o'clock \_\_M. in Book \_\_\_\_\_ of Maps Assessments and Community Facilities Districts at Pages \_\_\_\_\_ and as Instrument No. \_\_\_\_\_ In the offices of the County Recorder of Riverside County, State of California.

Fee: \$ \_\_\_\_\_

By: \_\_\_\_\_

County Recorder of Riverside County  
 Assessor-Clerk-Recorder Peter Aldana

Reference is hereby made to the Assessor maps of the County of Riverside for an exact description of the lines and dimensions of each lot and parcel.

**LEGEND**

	<b>Boundaries of Community Facilities District</b>
<b>#</b>	<b>Lot Number</b>
<b>NAP</b>	<b>Not a Part</b>

Lot Designation	
Lot No.	Assessor's Parcel No.
①	486-240-002
②	486-240-011

Prepared by:  
 KeyAnalytics